

## PowerSet Solo Power Charge Setting Times

POWERSET SIZE	SETTING FORCE*	75°F [24°C]	180°F [82°C]	250°F [121°C]
#10F	25,000 LBS	5 - 15 s	5 - 15 s	0 - 10 s
	35,000 LBS	5 - 20 s	5 - 20 s	0 - 10 s
#20	35,000 LBS	25 - 50 s	15 - 30 s	10 - 20 s
	45,000 LBS	30 - 60 s	15 - 30 s	10 - 20 s
	55,000 LBS	30 - 65 s	15 - 30 s	10 - 20 s

\*All PowerSet Recons are rated for use up to 55,000 lbs shear



T-Set #10



T-Set One

## T-Set Setting Tool Compatibility

COMPATIBLE T-SET SETTING TOOLS	POWERSET SOLO #10F HPC-0010-432	POWERSET SOLO #20 HPC-0020-531
T-SET ONE SETTING TOOL TSET-ONE-000	✓	
T-SET #10 SETTING TOOL WST-BK10-001	✓	
T-SET #10 NON-PORTED SETTING TOOL WST-BK10-201	✓	
T-SET #10 HIGH PRESSURE SETTING TOOL WST-BK10-002	✓	
T-SET #20 SETTING TOOL WST-BK20-001		✓
T-SET #20 NON-PORTED SETTING TOOL WST-BK20-201		✓
T-SET #20 HIGH PRESSURE SETTING TOOL WST-BK20-002		✓

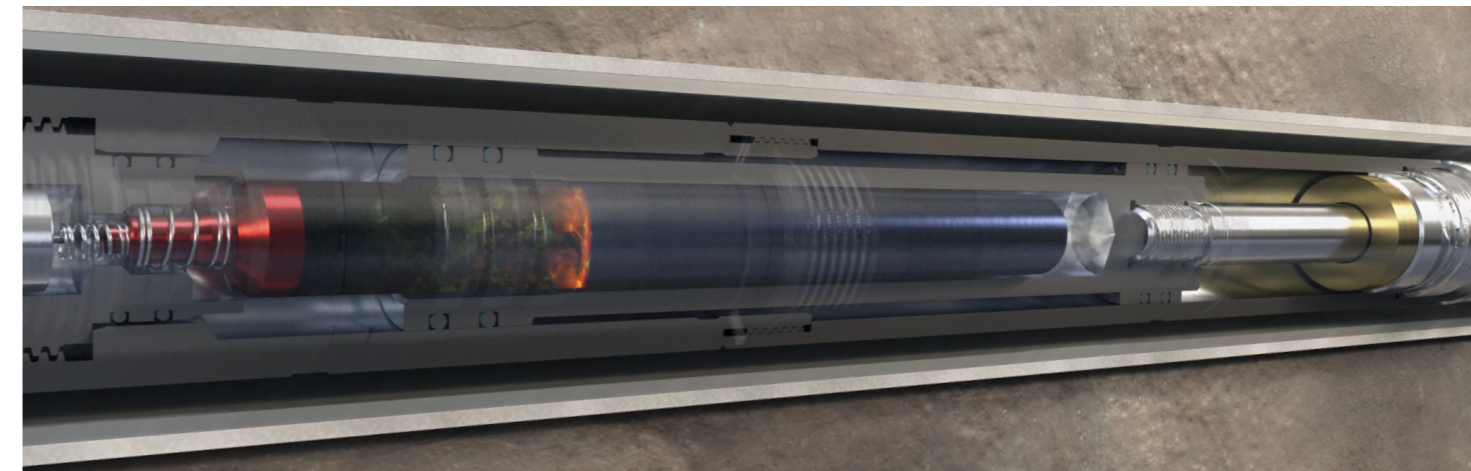

PowerSet Solo®



Power charge with built-in initiation device,  
Compatible Setting Tools, Hardware

### Further Information

#### Web

[www.hunting-intl.com](http://www.hunting-intl.com)

#### Email

[sales.titan@hunting-intl.com](mailto:sales.titan@hunting-intl.com)  
[support.titan@hunting-intl.com](mailto:support.titan@hunting-intl.com)

v2020.09.28

### Global Headquarters

**Hunting Energy Services Inc.**  
16825 Northchase Drive, Suite 600  
Houston, Texas 77060-3236  
USA  
T. +1 281 442 7382



'Excellence in Energy Services for over 100 years'

# PowerSet® Solo

www.hunting-intl.com/titan

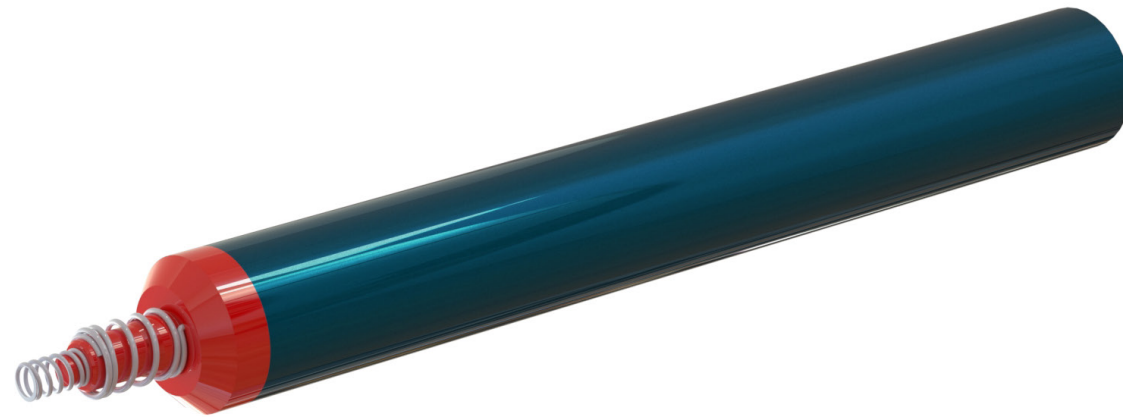

## Benefits ▶

- No igniter required
- Optimal, consistent setting times at temperature
- Compatible with existing setting tools
- Compatible with existing #10 & #20 firing heads
- Plug Shoot Cartridge (PSC) Firing Heads available

PowerSet® Solo is the only power charge with a built in initiation device.

## PowerSet Solo Charge Specifications

Specifications	PowerSet Solo #10F (Fast Burn)	PowerSet Solo #20
Part Number	HPC-0010-432	HPC-0020-531
Outside Diameter (in) [mm]	1.31 [33.27]	1.62 [41.15]
Length (in) [mm]	14.85 [377]	14.35 [364]
Max. 1 Hour Temp. Rating (°F) [°C]	350 [177]	350 [177]
Explosive Weight (kg)	0.4 kg	0.5 kg
Hazard Class	1.4C	1.4C
UN Number	0278	0278
DOT Number	EX2016020060	EX2016020060

## PowerSet Solo Hardware

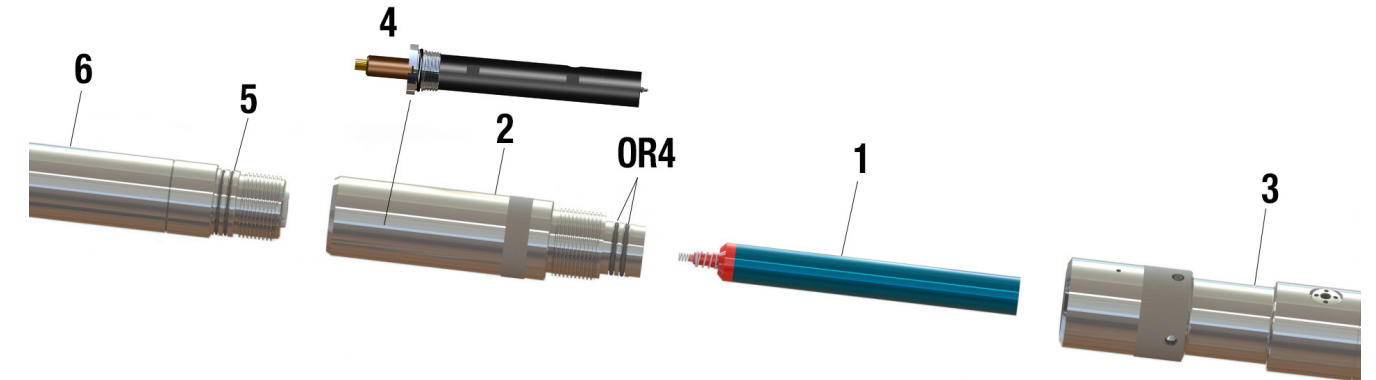

### For Use With Plug Shoot Cartridge (PSC) Firing Heads†

ID	Description	Part Number
1	PowerSet Solo #10F Power Charge (Fast Burn)	HPC-0010-432
	PowerSet Solo #20 Power Charge	HPC-0020-531
2	3-1/8" PowerSet Solo #10 PSC Firing Head	2010-312-200-IPC
	3-1/8" PowerSet Solo #20 PSC Firing Head	2020-312-200-IPC
3	T-Set® Setting Tool	See T-Set Setting Tool Compatibility Table
4	Plug Shoot Cartridge (PSC)	HTS-PSC-000
5	3-1/8" Esub Tandem Assy.	0363-ESUB-040B
	3-1/8" EB Tandem Assy.	0363-000-389A
6	Gun Assy; 6 Spf / 60° Phase	GUN
OR4	O-Ring; Nitrile (for #10)†	0111-222-090
	O-Ring; Nitrile (for #20)†	0111-328-090

Note: part numbers displayed are 3-1/8" O.D. for reference. 2-3/4" and 3-3/8" hardware is also available. | †Viton O-Rings required in applications above 325°F.

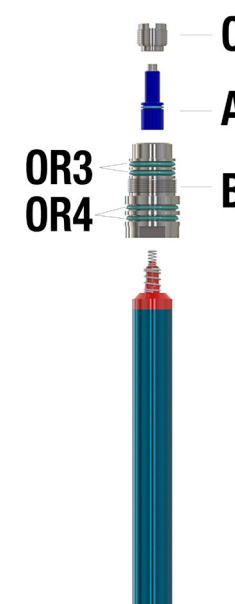

### For Use With Existing #10 & #20 Style Firing Heads†

ID	Description	Part Number
A	POWERSET SOLO CONTACT KIT for #10 & #20	2010-IPC-000-KIT
B	POWERSET SOLO CONTACT HOLDER for #10	2010-IPC-003
	POWERSET SOLO CONTACT HOLDER for #20	2020-IPC-003
C	POWERSET SOLO RETENTION RING for #10 & #20	2010-IPC-004
OR3	#10 O-RING; NITRILE*	0111-220-090
	#20 O-RING; NITRILE*	0111-325-090
OR4	#10 O-RING; NITRILE*	0111-222-090
	#20 O-RING; NITRILE*	0111-328-090

Note: for a full listing of sizes, compatibilities, and hardware, refer to manual. | Viton O-Rings required in applications above 325°F.\* | Firing Heads, hardware, and o-rings are sold separately.†